

Tok



design: Lombardo design department



Tok H150



Colori disponibili

Available colours - Couleurs disponibles

- Grigio High Tech
Grey High Tech - Gris High Tech
- Grigio antracite
Grey anthracite - Gris anthracite
- Corten

Materiale diffusore

Diffuser material - Type de diffuseur

- PMMA



IT Adatto anche ad uso esterno.

Corpo e testa in alluminio; elevata resistenza all'ossidazione grazie al trattamento di cataforesi, e alla verniciatura con resine poliesteri stabilizzate ai raggi UV.
Completo di staffa di fissaggio in tecnopolimero. Predisposto per installazione rapida su palo Ø 60 standard.
Tirafondi e minuteria per ancoraggio del palo al terreno incluso. Diffusore in PMMA trasparente antigraffio stabilizzato ai raggi UV.
Bulloneria in acciaio A4 con rivestimento in materiale termoplastico.
Fornito con 1m di cavo H05RN-F pre-cablato.
LED 4000K (N), 3000K (3) o 2700K (2). Alimentazione diretta 220 - 240V. Nessun rischio fotobiologico, RG0 gruppo di rischio esente (EN62471).

EN Also suitable for outdoor use.

Aluminum body and top; highly resistant to oxidation thanks to cataphoresis treatment and to the UV stabilized polyester resin painting.
Equipped with thermoplastic fixing bracket. Fitted for quick installation on standard Ø 60 post.
Fixing bolts and small metal parts to secure the base to the ground.
Diffuser made of transparent scratch-resistant UV stabilized PMMA.
A4 stainless steel bolts with thermoplastic coating. Provided with 1m of prewired cable H05RN-F.
LED 4000K (N), 3000K (3) or 2700K (2). LED. Integrated driver 220-240V. No risk of photobiological damage, RG0 group (EN62471).

FR Également adapté à l'usage à l'extérieur.

Corps et couverture en aluminium; haute résistance à l'oxydation grâce au traitement de cataphorèse et vernissage avec des résines polyester stabilisées aux UV.
Fourni avec étrier de fixation en technopolymère. Prédéposé pour l'installation rapide sur poteaux standards Ø 60.
Tire-fond et visserie pour l'ancrage du poteau au sol. Diffuseur réalisé en PMMA transparent et anti-rayures.
Visserie en acier inox type A4. Fourni avec 1 m de câble d'alimentation H05RN-F précablé.
LED 4000K (N), 3000K (3) ou 2700K (2) (blanche chaude). Alimentation intégrée 220-240. Pas de risque photobiologique, RG0 groupe (EN62471).

Completamento codici

Code completion - Complètement des codes

- colore led** - completare il codice sostituendo al quadrato rosso la lettera o il numero corrispondente alla temperatura colore scelta.

colour of the led - complete the code by replacing the red box with the letter or number corresponding to the selected colour temperature.

couleur led - compléter le code en remplaçant le carré rouge par la lettre ou le numéro correspondant à la sélection de température couleur.

- N = (4000K)
- 3 = (3000K, lumen -5%)
- 2 = (2700K, lumen -5%)

Predisposto per installazione su palo da Ø60 mm standard.

Suitable for installation on standard post Ø60 mm.
Prédéposé pour l'installation sur Poteau standard Ø60 mm.

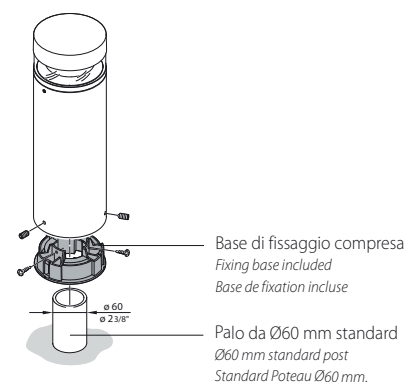
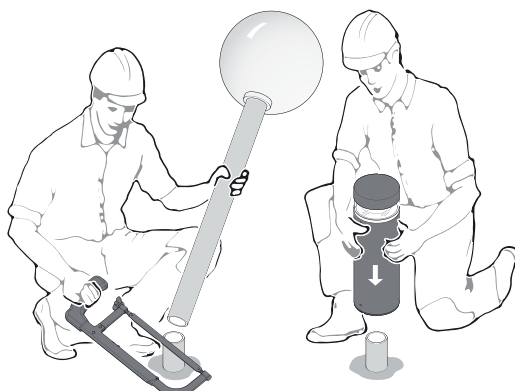



Tok C H150

IP 66 IK 10 20J xx9 CE

Emissione luminosa 180°.

Light beam 180°.

Angle d'éclairage 180°.



LED
930 lm 6,5W
real output lm 430

Specif.

CL.I E

Col.



Trasp.

LL128000
LL128001
LL128002

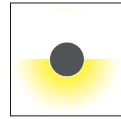
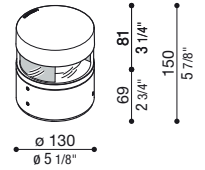

Emissione luminosa 180°
Light beam 180°
Angle de diffusion 180°

led colour

N = (4000K)
3 = (3000K, lm -5%)
2 = (2700K, lm -5%)



Tok H150

IP 66 IK 10 20J xx9 CE

Emissione luminosa 360°.

Light beam 360°.

Angle d'éclairage 360°.



LED
1860 lm 13W
real output lm 1010

Specif.

CL.I E

Col.



PMMA

LL128003
LL128004
LL128005

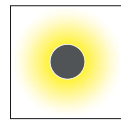
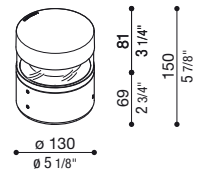

Emissione luminosa 360°
Light beam 360°
Angle de diffusion 360°

led colour

N = (4000K)
3 = (3000K, lm -5%)
2 = (2700K, lm -5%)



Tok C H400

IP 66 IK 10 20J xx9 CE

Emissione luminosa 180°.
Light beam 180°.
Angle d'éclairage 180°.

Emissione luminosa 180°
Light beam 180°
Angle de diffusion 180°

Specif.	Col.	Trasp.
LED 930 lm 6,5W real output lm 430 A A+ A++	■ ■ ▲	LL128006 LL128007 LL128008

led colour
N = (4000K)
3 = (3000K, lm -5%)
2 = (2700K, lm -5%)

Tok H400

IP 66 IK 10 20J xx9 CE

Emissione luminosa 360°.
Light beam 360°.
Angle d'éclairage 360°.

Emissione luminosa 360°
Light beam 360°
Angle de diffusion 360°

Specif.	Col.	Trasp.
LED 1860 lm 13W real output lm 1010 A A+ A++	■ ■ ▲	LL128009 LL128010 LL128011

led colour
N = (4000K)
3 = (3000K, lm -5%)
2 = (2700K, lm -5%)

Tok C H700

IP 66 IK 10 20J xx9 CE

Emissione luminosa 180°.
Light beam 180°.
Angle d'éclairage 180°.

Emissione luminosa 180°
Light beam 180°
Angle de diffusion 180°

Specif.	Col.	Trasp.
LED 930 lm 6,5W real output lm 430 A A+ A++	■ ■ ▲	LL128012 LL128013 LL128014

led colour
N = (4000K)
3 = (3000K, lm -5%)
2 = (2700K, lm -5%)

Tok H700

IP 66 IK 10 20J xx9 CE

Emissione luminosa 360°.
Light beam 360°.
Angle d'éclairage 360°.

Emissione luminosa 360°
Light beam 360°
Angle de diffusion 360°

Specif.	Col.	Trasp.
LED 1860 lm 13W real output lm 1010 A A+ A++	■ ■ ▲	LL128015 LL128016 LL128017

led colour
N = (4000K)
3 = (3000K, lm -5%)
2 = (2700K, lm -5%)

Tok

design: Lombardo design department

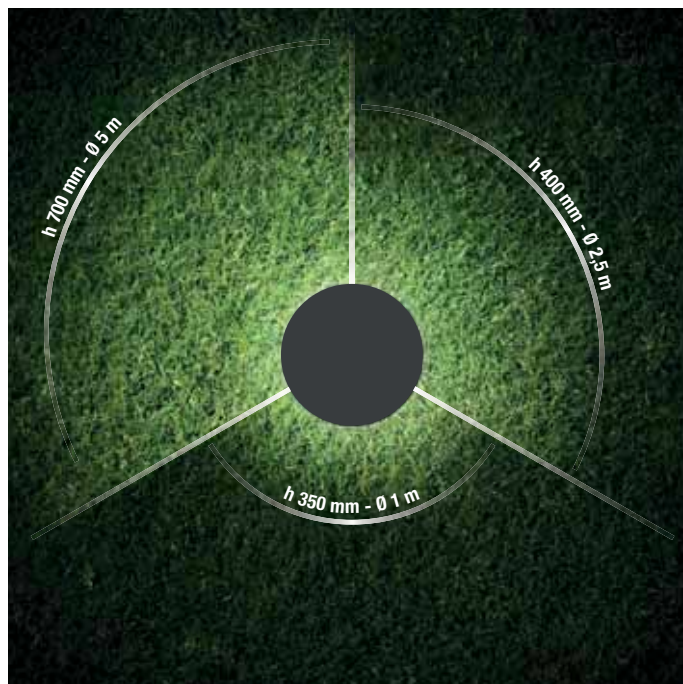

Scegliendo diverse altezze, varia l'area illuminata.
By choosing different heights, the lit area changes.
En choisissant des hauteurs différentes, la zone éclairée change.

